

**12 IDENTIFICATION OF PROBLEM**

NEXT

**13 REPAIR OR REPLACE**

NEXT

**14 CONFIRMATION TEST**

NEXT

END

CC

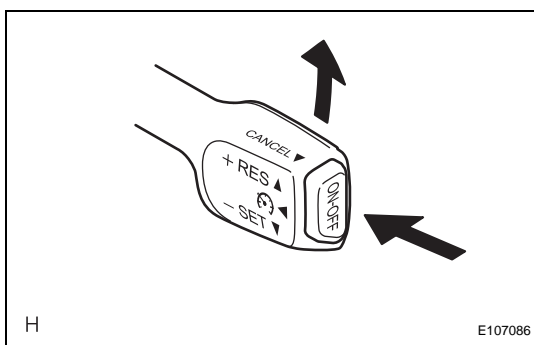
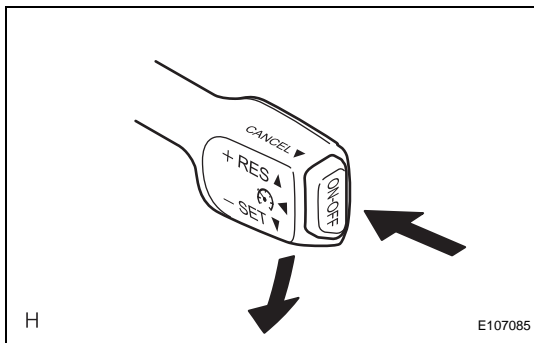
**ROAD TEST****1. PROBLEM SYMPTOM CONFIRMATION**

- (a) Inspect the SET function.
  - (1) Turn the cruise control main switch on.
  - (2) Drive at the required speed between 25 mph (40 km/h) and 125 mph (200 km/h).
  - (3) Push the cruise control main switch to - (COAST)/SET.
  - (4) After releasing the switch, check that the vehicle cruises at the set speed.
- (b) Inspect the ACCELERATION function.
  - (1) Turn the cruise control main switch on.
  - (2) Drive at the required speed between 25 mph (40 km/h) and 125 mph (200 km/h).
  - (3) Push the cruise control main switch to - (COAST)/SET.
  - (4) Check that the vehicle speed increases while the cruise control main switch is pushed to + (ACCEL)/RES (RESUME), and that the vehicle cruises at the newly set speed when the switch is released.
  - (5) Push the cruise control main switch to + (ACCEL)/RES (RESUME) and then release it immediately. Check that the vehicle speed increases by approximately 1.0 mph (1.6 km/h) (tap-up control).

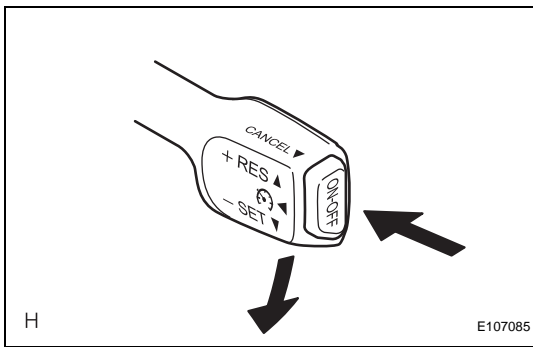

- (c) Inspect the - (COAST) function.
- (1) Turn the cruise control main switch on.
  - (2) Drive at the required speed between 25 mph (40 km/h) and 125 mph (200 km/h).
  - (3) Push the cruise control main switch to - (COAST)/SET.
  - (4) Check that the vehicle speed decreases while the cruise control main switch is pushed to - (COAST)/SET, and the vehicle cruises at the newly set speed when the switch is released.
  - (5) Push the cruise control main switch to - (COAST)/SET, and then release it immediately. Check that the vehicle speed decreases by approximately 1.0 mph (1.6 km/h) (tap-down control).

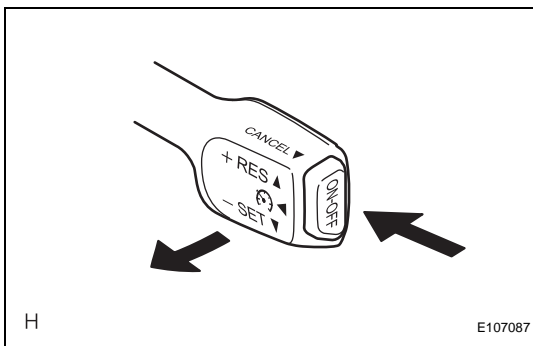

- (d) Inspect the CANCEL function.
- (1) Turn the cruise control main switch on.
  - (2) Drive at the required speed between 25 mph (40 km/h) and 125 mph (200 km/h).
  - (3) Push the cruise control main switch to - (COAST)/SET.
  - (4) When performing any one of the following, check that the cruise control system is canceled and that the normal driving mode is reset.
    - Depressing the brake pedal
    - Depressing the clutch pedal (M/T only)
    - The shift lever is moved from the D or 4th position to any of the N, 3rd , 2nd , or L positions (A/T only)
    - Turning the cruise control main switch off
    - Pulling the cruise control main switch to CANCEL

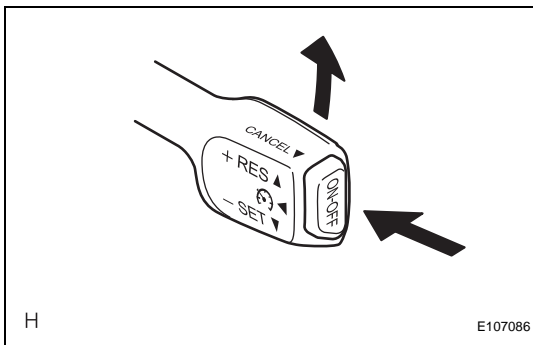

- (e) Inspect the RES (RESUME) function.
- (1) Turn the cruise control main switch on.
  - (2) Drive at the required speed between 25 mph (40 km/h) and 125 mph (200 km/h).
  - (3) Push the cruise control main switch to - (COAST)/SET.
  - (4) Cancel the cruise control system by performing any of the above operations (other than turning the main switch off).
  - (5) After pushing the cruise control main switch to + (ACCEL)/RES (RESUME) at a driving speed of more than 25 mph (40 km/h), check that the vehicle resumes the speed set prior to the cancellation.